

ROSLIN INNOVATION CENTRE

PROVIDING A FLEXIBLE WORKING ENVIRONMENT

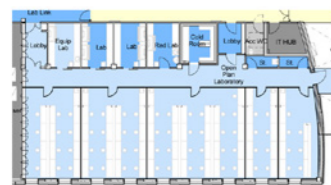
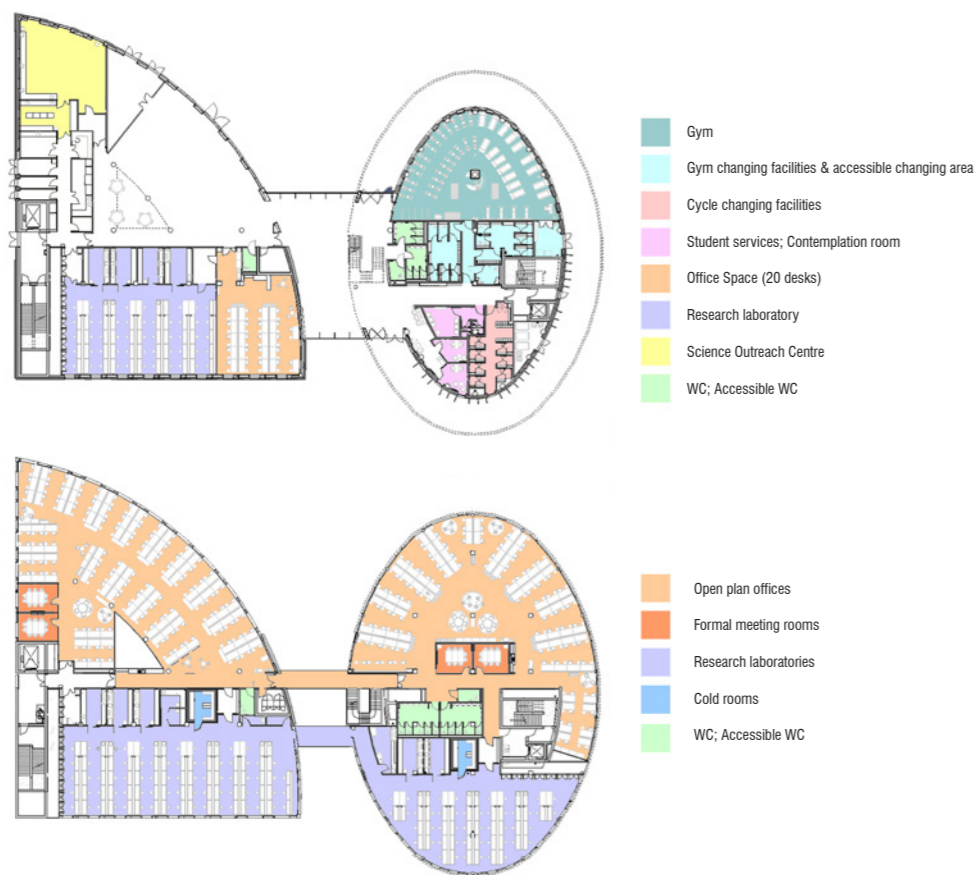

laboratories

Each of the laboratory spaces have been carefully designed so that they can be sub-divided into any configuration, whilst still maintaining shared access to the support areas and changing facilities. The whole building provides over 285 laboratory workstations.

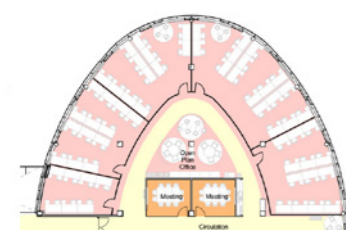

offices

The building also provides office space for up to 380 scientists. Like the laboratory space, these areas can also be subdivided into any configuration, whilst maintaining access to break out areas and meeting rooms.

CAMPUS SERVICES

Campus services, which will be provided to all tenants of the building, include:

- A manned reception from 8am to 8pm
- A Central Laboratory Support Unit providing a range of laboratory services including autoclave, glass-washing, slide and reagent preparation and a laboratory consumable service
- A wide range of bookable meeting rooms with audio visual and video conferencing capability

There is also access to other scientific facilities on the Campus including:

- Bio-Imaging and Flow Cytometry
- Edinburgh Genomics
- Easter Bush Pathology
- National Avian Research Facility

EASTER BUSH CAMPUS 2025 MASTERPLAN

The Campus Masterplan, produced in 2008, shows how the Campus is to expand over the following 25 years. In order to achieve the vision for the Easter Bush Campus it will be progressed in a number of staged developments.

The first phase of Campus development was completed at the end of 2012, providing facilities for clinical, teaching and research. In addition, investment was also made in the Campus environment and infrastructure.

The second phase of development was completed at the end of 2014 with two projects linked to the National Avian Research Facility.

The third phase of development commenced March 2015 with the building of the Roslin Innovation Centre, alongside further Campus infrastructure including an Energy Centre both scheduled to complete in the summer of 2017.

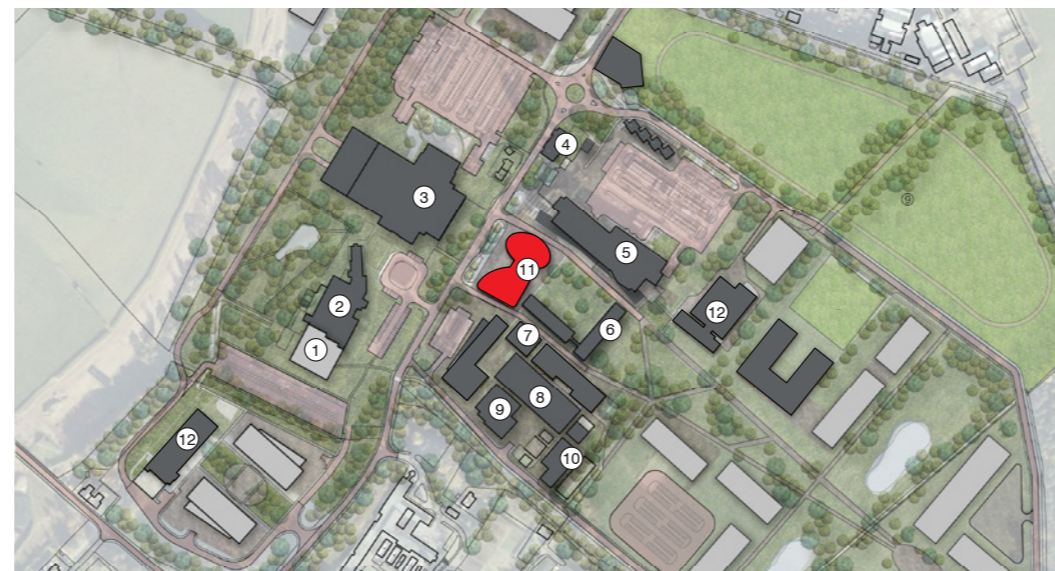

- Riddell-Swan Veterinary Cancer Centre
- Hospital for Small Animals
- Royal (Dick) School of Veterinary Studies - Teaching Building
- Campus Service Centre
- The Roslin Institute Building
- Sir Alexander Robertson Building (currently acting as a 'pop up incubator')
- Farm Animal Practice and Equine Clinical Unit
- Equine Hospital
- Farm Animal Hospital
- Scintigraphy and Exotic Animal Unit
- Roslin Innovation Centre**
- National Avian Research Facility

FURTHER INFORMATION

If you wish any further information relating to opportunities available on the Easter Bush Campus or wish to discuss locating your business at the Roslin Innovation Centre, please contact:

John Mackenzie
Chief Executive Officer
Roslin Innovation Centre

0131 651 9100
john.mackenzie@roslin.ed.ac.uk
www.roslininnovationcentre.com

www.easterbush.mvm.ed.ac.uk

The Roslin Institute
The University of Edinburgh
Easter Bush Campus
Midlothian EH25 9RG



THE UNIVERSITY of EDINBURGH
The Royal (Dick) School
of Veterinary Studies

The Roslin Innovation Centre and Campus Hub has been funded by:



THE UNIVERSITY of EDINBURGH



THE UNIVERSITY of EDINBURGH
Easter Bush Campus

is part of



Building Contractors



McLaughlin & Harvey



41,000 sq ft of flexible lab and office
space available for let



The business location of
choice for companies undertaking
strategic, commercial and collaborative
research in the Animal and Veterinary Sciences;
Agri Tech and One Health industries



THE UNIVERSITY of EDINBURGH
Easter Bush Campus



THE UNIVERSITY of EDINBURGH

The University of Edinburgh, founded in 1583, is the sixth-oldest university in the English-speaking world and one of Scotland's ancient universities. It was the fourth university to be established in Scotland and the sixth in the United Kingdom, and is regarded as one of the most prestigious universities in the world. The University of Edinburgh is consistently ranked

as one of the world's top 50 universities. In 2015, the University was ranked 21st in the world in the QS World University Rankings. It is a member of both the Russell Group, and the League of European Research Universities. It has the third largest endowment of any university in the United Kingdom, after the universities of Cambridge and Oxford.

WELCOME TO EASTER BUSH CAMPUS

Delivering Excellence in Animal Science and Food Security

One Biology/One Health

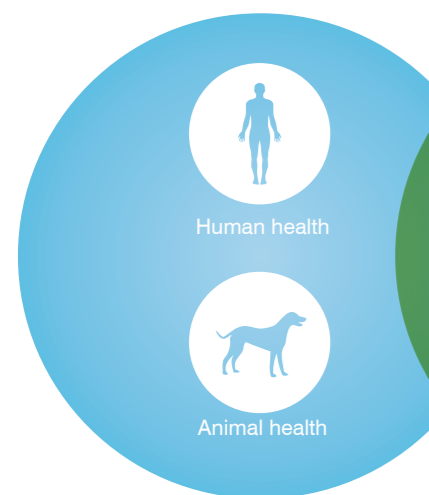

Food & Environmental Security

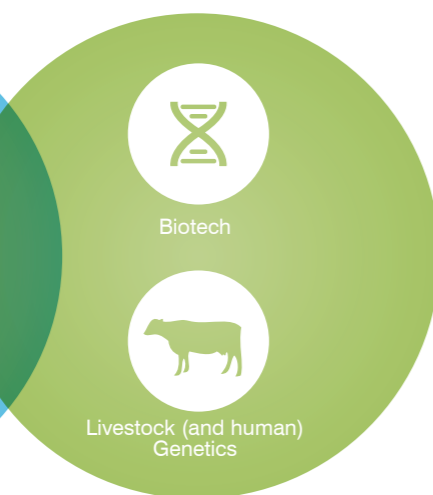

The overall aim of the Roslin Innovation Centre is to provide an iconic gateway building that will...

“bring together the clinical teaching, research and enterprise activities into a vibrant, interactive core at the heart of the innovation and research campus of Easter Bush.”

The building provides a space where people can communicate physically and intellectually, and provides a gathering space that allows meeting and interaction from across the Campus, whilst also serving as an information point for the general public. The location of the Roslin Innovation Centre at the heart of the Campus allows for the natural development of business collaborators with laboratory and office space situated close to the science and clinical livestock expertise.

The Roslin Innovation Centre is therefore a key component of the overall Campus Masterplan for Easter Bush, forming an integral part of the significant investment being made by the University of Edinburgh in the Campus. The design for the building also meets the requirements set out in the University's Sustainability agenda.

The new building will deliver the aims and ambitions of the College of Medicine and Veterinary Medicine which include:

- Providing a 'world leading centre of veterinary research, education and clinical care' which reflects the on-going synergy between the Royal (Dick) School of Veterinary Studies and The Roslin Institute



INDUSTRY



SERVICES



SCIENCE



OUTREACH

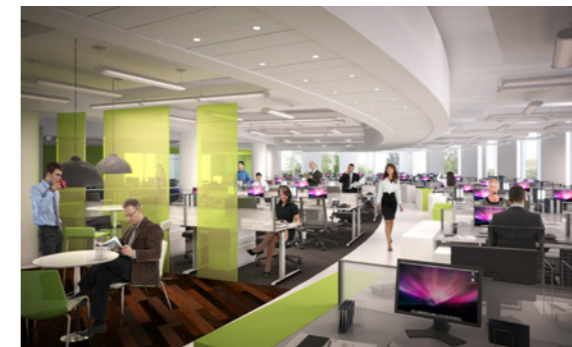

OFFICES

The office spaces provide bright and airy write up areas next door to the laboratory accommodation.

Full height glazing affords views out to the adjacent countryside. Break out areas and meeting rooms allow for closer collaborative working. The design and layout of these spaces allow for easy sub-division. The office area will provide space for over 380 scientists.

LABORATORIES

Like the write up spaces, the laboratories can be easily sub-divided and offer fully flexible accommodation. Again views out of the building are maximised through large areas of external glazing. The laboratories, whether left as open plan or sub-divided, provide access to the shared support areas, such as tissue culture rooms, cold rooms, dark rooms and changing facilities. Over 285 laboratory workstations will be provided.



The Easter Bush Research Consortium (EBRC) brings together **The Roslin Institute**, Animal Sciences researchers of **Scotland's Rural College (SRUC)**, **The Royal (Dick) School of Veterinary Studies** and the **Moredun Research Institute**. Together, the EBRC forms one of the largest groups focussed on the biology of companion and production animals in the world. It undertakes basic and translational science to tackle pressing issues in animal genetics and genomics, development, health and welfare, and their implications for human health.

www.ebrc.ac.uk



The Easter Bush Campus allows delivery of solutions to global challenges within the veterinary and livestock industries.

Livestock farming remains a major industry in the UK, crucial to the life and sustainability of rural communities. Sustainable increases in the productivity of the agriculture sector are required to address the future food security of the UK and the world.

The Easter Bush Campus has the largest concentration of animal science related expertise anywhere in Europe. It aims to become internationally recognised in animal science by 2025, leading efforts to address livestock

improvement, food security and alleviation of poverty in developing countries.

The Easter Bush Campus provides a dynamic and vibrant working environment with world class facilities equipped with the latest technologies.

This allows us to continue to attract scientists and clinicians of the highest quality for our research and to enhance our collaborative research environment which sustains and expands our links with industry.

The Easter Bush Campus acts as a hub of activity bringing together our partners and other stakeholders within the region and beyond.

- Teaching and exhibition space through a Science Outreach Centre for the wider community
- Providing ancillary accommodation such as a gym, shop and support services for staff, students, tenants and visitors to the Campus

The Roslin Innovation Centre plays a fundamental role in:

- Supporting The Roslin Institute/Royal (Dick) School of Veterinary Studies/Scotland's Rural College (SRUC) spin-off commercial activities
- Attracting and developing bioscience companies at different stages of maturity, including company start-up capacity



- Providing research and development partnering opportunities with access to Campus expertise and facilities
- Extending and promoting collaboration between research-intensive companies and the UK bioscience research base



SHARED FACILITIES

This building will be the gateway to the rest of the Campus, with shared Campus facilities such as a shop, gym and student services, all located on the ground floor.